

POPPET SCREW - QC - STC SERIES

METRIC (L) BULKHEAD



[CLICK HERE FOR 3D SECTION](#)

TECHNICAL FEATURES AND OPTIONS

Locking Mechanism Screw to Connect	Flow Rate Up to 189 l / min	Material Carbon Steel Stainless Steel
Working Temperature -20 °C / +90 °C	Interchange ISO 14541	How to Connect Screw
Operating Pressure Up to 350 Bar	Available Threads BSP - NPT - Metric - SAE	Under Residual Pressure Connction: Both Side Disconnection: Allowed
Available Sizes From 1/4" to 1"	Sealing Description NBR - FKM	Valve Type Poppet

MAIN APPLICATIONS

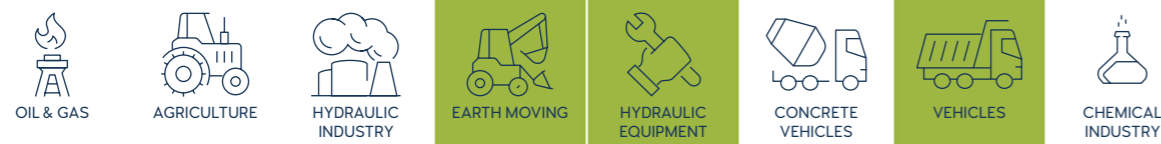

INFORMATION

- Connection under residual pressure is allowed on both sides.
- Disconnection under residual pressure is allowed.
- Top quality elastomer seals provide maximum sealing.
- The external sealing ring ensures a solid connection and prevents disconnection due to vibration.
- The design prevents pressure drops and turbulences.
- Durable, safe, compact and easy to use design.
- Please clean the mating surfaces thoroughly before connecting, in order to prevent contaminants to enter into the system.
- Please make sure that the male and female parts are aligned properly to achive full connection.

WARNING

- Connection and disconnection under dynamic pressure is not allowed.
- Connection and disconnection is not allowed when the temperature of the circulating fluid is above 80°C / 176°F.
- Make sure the system pressure is below the maximum working pressure.
- Please ensure that the OLEOCON product you have chosen is compatible with the temperature, material and pressure requirements of your system.
- Please contact OLEOCON technical support for any further questions.

TECHNICAL DRAWING

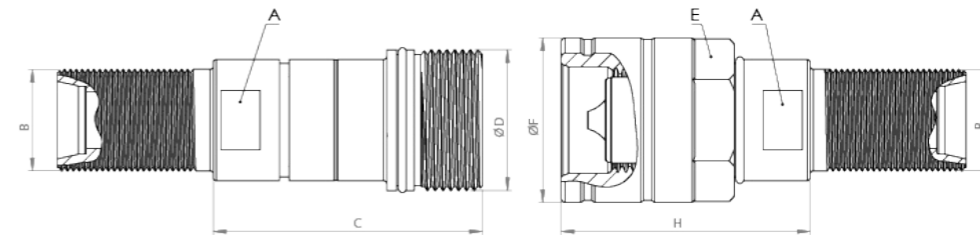

BODY SIZE	DESCRIPTION	COUPLING GENDER	THREAD TYPE	Hex		THREAD SIZE(B)	DIAMETER		LENGTH		WEIGHT				
				mm	inch		mm	inch	mm	inch	kg	lbs			
6,3	QC-STC-6A-M6L-BH	FEMALE	BSP	A	17	0.66	M12*1.5	D	M24*2	-	C	61.7	2.42	0.25	0.55
	QC-STC-6B-M6L-BH	MALE	BSP	E	30	1.18	M12*1.5	F	34	-	H	59	2.32	0.16	0.352
10	QC-STC-10A-M8L-BH	FEMALE	BSP	A	22	0.86	M14*1.5	D	M28*2	-	C	62.9	2.47	0.24	0.528
	QC-STC-10B-M8L-BH	MALE	BSP	E	30	1.18	M14*1.5	F	34	-	H	60.5	2.38	0.21	0.462
	QC-STC-10A-M10L-BH	FEMALE	BSP	A	22	0.86	M16*1.5	D	M28*2	-	C	62.9	2.47	0.25	0.55
	QC-STC-10B-M10L-BH	MALE	BSP	E	30	1.18	M16*1.5	F	34	-	H	60.5	2.38	0.22	0.484
	QC-STC-10A-M12L-BH	FEMALE	BSP	A	22	0.86	M18*1.5	D	M28*2	-	C	62.9	2.47	0.26	0.572
	QC-STC-10B-M12L-BH	MALE	BSP	E	30	1.18	M18*1.5	F	34	-	H	60.5	2.38	0.23	0.506
12,5	QC-STC-12A-M12L-BH	FEMALE	BSP	A	27	1.06	M18*1.5	D	M36*2	-	C	69	2.71	0.38	0.836
	QC-STC-12B-M12L-BH	MALE	BSP	E	36	1.41	M18*1.5	F	42.1	-	H	63.8	2.51	0.37	0.814
	QC-STC-12A-M15L-BH	FEMALE	BSP	A	27	1.06	M22*1.5	D	M36*2	-	C	69	2.71	0.4	0.88
	QC-STC-12B-M15L-BH	MALE	BSP	E	36	1.41	M22*1.5	F	42.1	-	H	63.8	2.51	0.39	0.858
	QC-STC-12A-M18L-BH	FEMALE	BSP	A	27	1.06	M26*1.5	D	M36*2	-	C	69	2.71	0.42	0.924
	QC-STC-12B-M18L-BH	MALE	BSP	E	36	1.41	M26*1.5	F	42.1	-	H	63.8	2.51	0.41	0.902
19	QC-STC-20A-M15L-BH	FEMALE	BSP	A	32	1.25	M22*1.5	D	M42*2	-	C	85.5	3.36	0.59	1.298
	QC-STC-20B-M15L-BH	MALE	BSP	E	41	1.61	M22*1.5	F	48.5	-	H	76	2.99	0.57	1.254
	QC-STC-20A-M18L-BH	FEMALE	BSP	A	32	1.25	M26*1.5	D	M42*2	-	C	85.5	3.36	0.62	1.364
	QC-STC-20B-M18L-BH	MALE	BSP	E	41	1.61	M26*1.5	F	48.5	-	H	76	2.99	0.6	1.32
	QC-STC-20A-M22L-BH	FEMALE	BSP	A	32	1.25	M30*2	D	M42*2	-	C	85.5	3.36	0.63	1.386
	QC-STC-20B-M22L-BH	MALE	BSP	E	41	1.61	M30*2	F	48.5	-	H	76	2.99	0.61	1.342
25	QC-STC-25A-M18L-BH	FEMALE	BSP	A	41	1.61	M26*1.5	D	M48*3	-	C	97.5	3.83	0.85	1.87
	QC-STC-25B-M18L-BH	MALE	BSP	E	50	1.96	M26*1.5	F	54.5	-	H	82	3.22	0.88	1.936
	QC-STC-25A-M22L-BH	FEMALE	BSP	A	41	1.61	M30*2	D	M48*3	-	C	97.5	3.83	0.86	1.892
	QC-STC-25B-M22L-BH	MALE	BSP	E	50	1.96	M30*2	F	54.5	-	H	82	3.22	0.89	1.958
	QC-STC-25A-M28L-BH	FEMALE	BSP	A	41	1.61	M36*2	D	M48*3	-	C	97.5	3.83	0.87	1.914
	QC-STC-25B-M28L-BH	MALE	BSP	E	50	1.96	M36*2	F	54.5	-	H	82	3.22	0.9	1.98

ISO 8434-1

BODY SIZE	WORKING PRESSURE						BURST PRESSURE					
	COUPLE		FEMALE		MALE		COUPLE		FEMALE		MALE	
	MPa	PSI	MPa	PSI	MPa	PSI	MPa	PSI	MPa	PSI	MPa	PSI
6	35	5075	35	5075	35	5075	140	20300	140	20300	140	20300
10	30	4350	30	4350	30	4350	120	17400	120	17400	120	17400
12,5	30	4350	30	4350	30	4350	120	17400	120	17400	120	17400
19	25	3625	25	3625	25	3625	100	14500	100	14500	100	14500
25	20	2900	20	2900	20	2900	80	11600	80	11600	80	11600

POPPET SCREW - QC - STC SERIES

METRIC (S) BULKHEAD

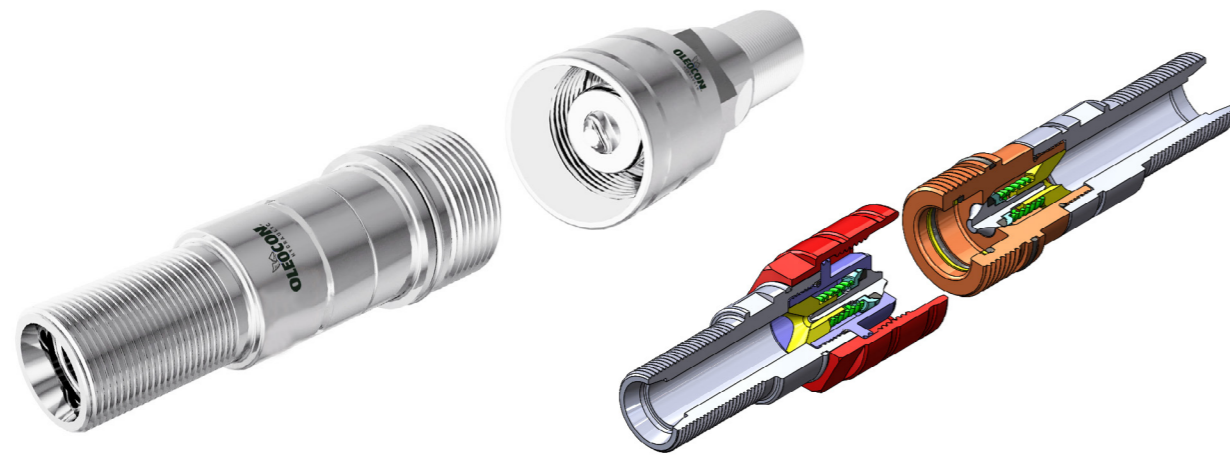

[CLICK HERE FOR 3D SECTION](#)

TECHNICAL FEATURES AND OPTIONS

Locking Mechanism Screw to Connect	Flow Rate Up to 189 l / min	Material Carbon Steel Stainless Steel
Working Temperature -20 °C / +90 °C	Interchange ISO 14541	How to Connect Screw
Operating Pressure Up to 350 Bar	Available Threads BSP - NPT - Metric - SAE	Under Residual Pressure Connction: Both Side Disconnection: Allowed
Available Sizes From 1/4" to 1"	Sealing Description NBR - FKM	Valve Type Poppet

MAIN APPLICATIONS

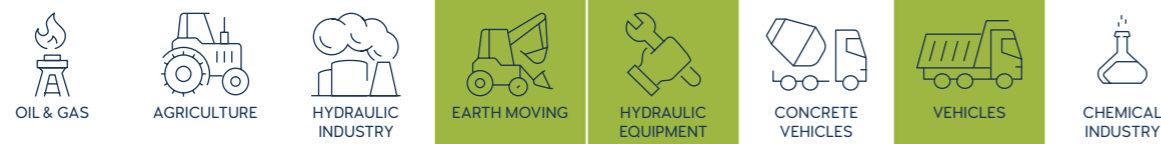

INFORMATION

- Connection under residual pressure is allowed on both sides.
- Disconnection under residual pressure is allowed.
- Top quality elastomer seals provide maximum sealing.
- The external sealing ring ensures a solid connection and prevents disconnection due to vibration.
- The design prevents pressure drops and turbulences.
- Durable, safe, compact and easy to use design.
- Please clean the mating surfaces thoroughly before connecting, in order to prevent contaminants to enter into the system.
- Please make sure that the male and female parts are aligned properly to achive full connection.

WARNING

- Connection and disconnection under dynamic pressure is not allowed.
- Connection and disconnection is not allowed when the temperature of the circulating fluid is above 80°C / 176°F.
- Make sure the system pressure is below the maximum working pressure.
- Please ensure that the OLEOCON product you have chosen is compatible with the temperature , material and pressure requirements of your system.
- Please contact OLEOCON technical support for any further questions.

TECHNICAL DRAWING

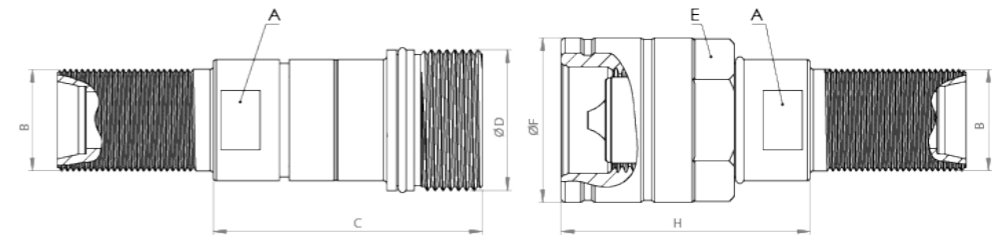

BODY SIZE	DESCRIPTION	COUPLING GENDER	THREAD TYPE	Hex		THREAD SIZE (B)	DIAMETER		LENGTH		WEIGHT				
				mm	inch		mm	inch	mm	inch	kg	lbs			
6,3	QC-STC-6A-M6S-BH	FEMALE	BSP	A	17	0.66	M14*1.5	D	M24*2	-	C	61,7	2,42	0,26	0,572
	QC-STC-6B-M6S-BH	MALE	BSP	E	30	1,18	M14*1.5	F	34	-	H	59	2,32	0,17	0,374
10	QC-STC-10A-M8S-BH	FEMALE	BSP	A	22	0,86	M16*1,5	D	M28*2	-	C	62,9	2,47	0,26	0,572
	QC-STC-10B-M8S-BH	MALE	BSP	E	30	1,18	M16*1,5	F	34	-	H	60,5	2,38	0,23	0,506
	QC-STC-10A-M10S-BH	FEMALE	BSP	A	22	0,86	M18*1,5	D	M28*2	-	C	62,9	2,47	0,27	0,594
	QC-STC-10B-M10S-BH	MALE	BSP	E	30	1,18	M18*1,5	F	34	-	H	60,5	2,38	0,24	0,528
	QC-STC-10A-M12S-BH	FEMALE	BSP	A	22	0,86	M20*1,5	D	M28*2	-	C	62,9	2,47	0,28	0,616
	QC-STC-10B-M12S-BH	MALE	BSP	E	30	1,18	M20*1,5	F	34	-	H	60,5	2,38	0,25	0,55
12,5	QC-STC-12A-M10S-BH	FEMALE	BSP	A	27	1,06	M18*1,5	D	M36*2	-	C	69	2,71	0,39	0,858
	QC-STC-12B-M10S-BH	MALE	BSP	E	36	1,41	M18*1,5	F	42,1	-	H	63,8	2,51	0,38	0,836
	QC-STC-12A-M12S-BH	FEMALE	BSP	A	27	1,06	M20*1,5	D	M36*2	-	C	69	2,71	0,41	0,902
	QC-STC-12B-M12S-BH	MALE	BSP	E	36	1,41	M20*1,5	F	42,1	-	H	63,8	2,51	0,4	0,88
	QC-STC-12A-M16S-BH	FEMALE	BSP	A	27	1,06	M24*1,5	D	M36*2	-	C	69	2,71	0,43	0,946
	QC-STC-12B-M16S-BH	MALE	BSP	E	36	1,41	M24*1,5	F	42,1	-	H	63,8	2,51	0,42	0,924
19	QC-STC-20A-M12S-BH	FEMALE	BSP	A	32	1,25	M20*1,5	D	M42*2	-	C	85,5	3,36	0,61	1,342
	QC-STC-20B-M12S-BH	MALE	BSP	E	41	1,61	M20*1,5	F	48,5	-	H	76	2,99	0,59	1,298
	QC-STC-20A-M16S-BH	FEMALE	BSP	A	32	1,25	M24*1,5	D	M42*2	-	C	85,5	3,36	0,63	1,386
	QC-STC-20B-M16S-BH	MALE	BSP	E	41	1,61	M24*1,5	F	48,5	-	H	76	2,99	0,61	1,342
	QC-STC-20A-M20S-BH	FEMALE	BSP	A	32	1,25	M30*2	D	M42*2	-	C	85,5	3,36	0,67	1,474
	QC-STC-20B-M20S-BH	MALE	BSP	E	41	1,61	M30*2	F	48,5	-	H	76	2,99	0,65	1,43
25	QC-STC-25A-M16S-BH	FEMALE	BSP	A	41	1,61	M24*1,5	D	M48*3	-	C	97,5	3,83	0,85	1,87
	QC-STC-25B-M16S-BH	MALE	BSP	E	50	1,96	M24*1,5	F	54,5	-	H	82	3,22	0,88	1,936
	QC-STC-25A-M20S-BH	FEMALE	BSP	A	41	1,61	M30*2	D	M48*3	-	C	97,5	3,83	0,9	1,98
	QC-STC-25B-M20S-BH	MALE	BSP	E	50	1,96	M30*2	F	54,5	-	H	82	3,22	0,93	2,046
	QC-STC-25A-M25S-BH	FEMALE	BSP	A	41	1,61	M36*2	D	M48*3	-	C	97,5	3,83	0,96	2,112
	QC-STC-25B-M25S-BH	MALE	BSP	E	50	1,96	M36*2	F	54,5	-	H	82	3,22	0,99	2,178

ISO-8434-1

BODY SIZE	WORKING PRESSURE						BURST PRESSURE					
	COUPLE		FEMALE		MALE		COUPLE		FEMALE		MALE	
	MPa	PSI	MPa	PSI	MPa	PSI	MPa	PSI	MPa	PSI	MPa	PSI
6	35	5075	35	5075	35	5075	140	20300	140	20300	140	20300
10	30	4350	30	4350	30	4350	120	17400	120	17400	120	17400
12,5	30	4350	30	4350	30	4350	120	17400	120	17400	120	17400
19	25	3625	25	3625	25	3625	100	14500	100	14500	100	14500
25	20	2900	20	2900	20	2900	80	11600	80	11600	80	11600