

FLAT FACE - QCF SERIES



TECHNICAL FEATURES AND OPTIONS

3D SECTION

 Locking Mechanism Locking Ball System + Safety Lock	 Flow Rate Up to 189 l / min	 Material Carbon Steel Stainless Steel Brass
 Working Temperature -20 °C / +90 °C	 Interchange 16028	 Connection System Push
 Operating Pressure Up to 250 Bar	 Available Threads BSP - NPT - Metric - SAE	 Connection Under Pressure Connction: Not Allowed Disconnection: Not Allowed
 Body Sizes ISO 10-25	 Sealing Description NBR - FKM	 Valving Style Flat Face

MAIN APPLICATIONS

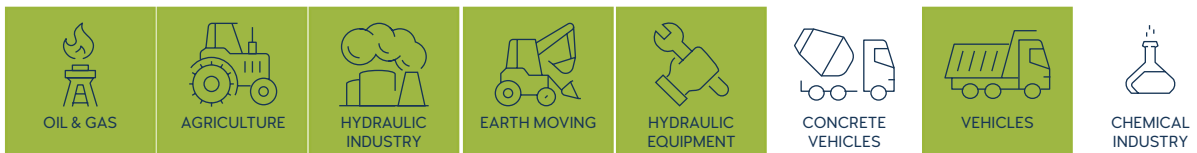

WARNING

- Connection or disconnection during flow and under dynamic pressure is not allowed.
- Connection or Disconnection is not allowed when the internal circuit temperature is higher than 80°C / 176°F
- Usage over the maximum working pressures is not allowed.
- Please ensure that the OLEOCON product series you have chosen is compatible with the temperature , material and pressure requirements of your system.
- Please contact with OLEOCON technical support for any further questions.

INFORMATION

- Flat face design prevents dirt or dust accumulation in the circuit.
- Environment friendly design which prevents fluid spillage during disconnection.
- Top quality sealing rings provides high level of protection.
- Linear flow prevents pressure drops and turbulences.
- Durable, safe, compact and simple to use design.
- Please ensure the cleanliness of all connection surfaces to avoid dirt or dust accumulation in the circuit.
- Please ensure the alignment and full connection of male and female parts.
- Safety lock feature prevents accidental disconnection.

TECHNICAL DRAWING

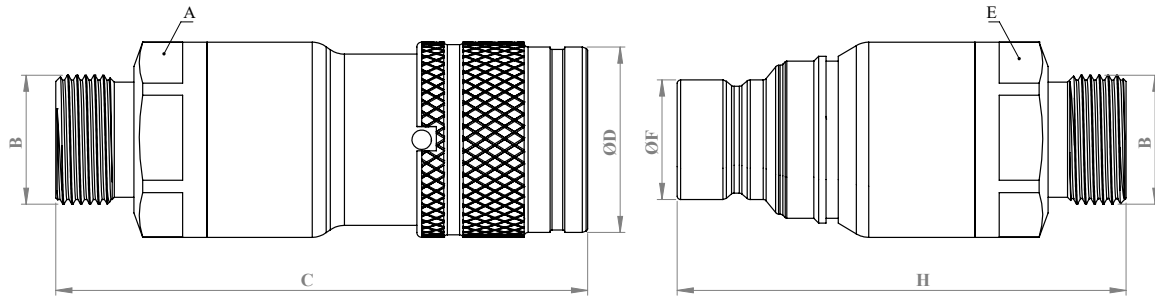

BODY SIZE	DESCRIPTION	COUPLING GENDER	Hex		THREAD SIZE(B)	DIAMETER			LENGTH		WEIGHT			
			mm	inch		mm	inch	mm	inch	kg	lbs			
06	QCF-6A-G14M	FEMALE	A	-	-	1/4	D	-	-	C	-	-	-	
	QCF-6B-G14M	MALE	E	-	-	1/4	F	-	-	H	-	-	-	
10	QCF-10A-G38M	FEMALE	A	30	1,18	3/8	D	32	1,25	C	84	3,30	0,39	0,858
	QCF-10B-G38M	MALE	E	30	1,18	3/8	F	19,7	0,77	H	74	2,91	0,25	0,55
	QCF-10A-G12M	FEMALE	A	30	1,18	1/2	D	32	1,25	C	83	3,26	0,4	0,88
	QCF-10B-G12M	MALE	E	30	1,18	1/2	F	19,7	0,77	H	73	2,87	0,26	0,572
12.5	QCF-12A-G12M	FEMALE	A	36	1,41	1/2	D	38	1,49	C	99	3,89	0,64	1,408
	QCF-12B-G12M	MALE	E	36	1,41	1/2	F	24,5	0,96	H	82	3,22	0,41	0,902
	QCF-12A-G34M	FEMALE	A	36	1,41	3/4	D	38	1,49	C	98	3,85	0,64	1,408
	QCF-12B-G34M	MALE	E	36	1,41	3/4	F	24,5	0,96	H	81	3,18	0,41	0,902
19	QCF-19A-G34M	FEMALE	A	41	1,61	3/4	D	46,1	1,81	C	116	4,56	0,98	2,156
	QCF-19B-G34M	MALE	E	41	1,61	3/4	F	29,9	1,17	H	97	3,81	0,6	1,32
	QCF-19A-G1M	FEMALE	A	41	1,61	1	D	46,1	1,81	C	115	4,52	0,99	2,178
	QCF-19B-G1M	MALE	E	41	1,61	1	F	29,9	1,17	H	96	3,77	0,61	1,342
25	QCF-25A-G1M	FEMALE	A	50	1,96	1	D	55	2,16	C	123	4,84	1,64	3,608
	QCF-25B-G1M	MALE	E	50	1,96	1	F	36	1,41	H	106	4,17	0,96	2,112
	QCF-25A-G114M	FEMALE	A	55	2,16	1 1/4	D	55	2,16	C	121	4,76	1,55	3,41
	QCF-25B-G114M	MALE	E	55	2,16	1 1/4	F	36	1,41	H	104	4,09	0,97	2,134

ISO 8434-6

BODY SIZE	WORKING PRESSURE						BURST PRESSURE					
	COUPLE		FEMALE		MALE		COUPLE		FEMALE		MALE	
	MPa	PSI	MPa	PSI	MPa	PSI	MPa	PSI	MPa	PSI	MPa	PSI
6	-	-	-	-	-	-	-	-	-	-	-	-
10	25	3625	25	3625	25	3625	100	14500	100	14500	100	14500
12.5	25	3625	25	3625	25	3625	100	14500	100	14500	100	14500
19	25	3625	25	3625	25	3625	100	14500	100	14500	100	14500
25	20	2900	20	2900	20	2900	80	11600	80	11600	80	11600