

# POPET TYPE - QCA SERIES



## TECHNICAL FEATURES AND OPTIONS

## 3D SECTION

	<p><b>Locking Mechanism</b> Screw to Connect</p>		<p><b>Flow Rate</b> Up to 757 l / min</p>		<p><b>Material</b> Carbon Steel Stainless Steel Brass</p>
	<p><b>Working Temperature</b> -20 °C / +90 °C</p>		<p><b>Interchange</b> ISO 7241-A</p>		<p><b>Connection System</b> Single Action Sleeve</p>
	<p><b>Operating Pressure</b> Up to 315 Bar</p>		<p><b>Available Threads</b> BSP - NPT - Metric - SAE</p>		<p><b>Connection Under Pressure</b> Connection: not Allowed Disconnection: not Allowed</p>
	<p><b>Body Sizes</b> ISO 6.3 - 50</p>		<p><b>Sealing Description</b> NBR - FKM</p>		<p><b>Valving Style</b> Popet</p>

## MAIN APPLICATIONS

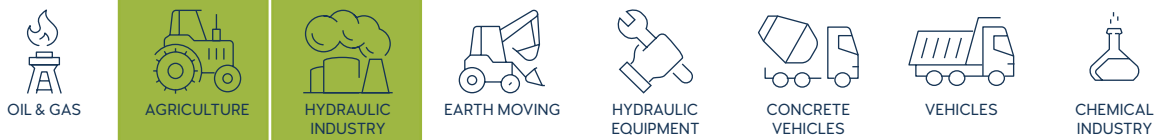

**WARNING**

- Connection or disconnection during flow and under dynamic pressure is not allowed.
- Connection or Disconnection is not allowed when the internal circuit temperature is higher than 80°C / 176°F
- Usage over the maximum working pressures is not allowed.
- Please ensure that the OLEOCON product series you have chosen is compatible with the temperature , material and pressure requirements of your system.
- Please contact with OLEOCON technical support for any further questions.

**INFORMATION**

- Do not connect or remove the counterparts under residual pressure.
- Top quality sealing rings provides high level of protection.
- The designs are developed to prevent pressure drops and turbulences.
- Durable and simple to use design.
- Please ensure the cleanliness of all connection surfaces to avoid dirt or dust accumulation in the circuit.
- Please ensure the alignment and full connection of male and female parts.

## TECHNICAL DRAWING

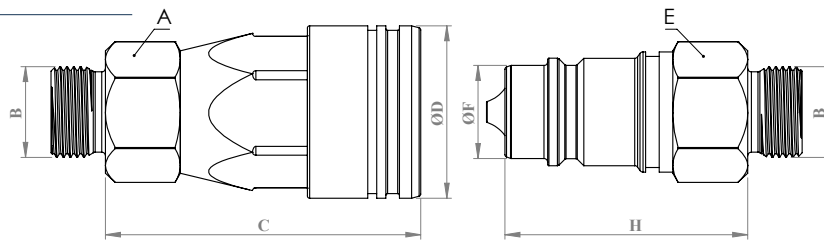

BODY SIZE	DESCRIPTION	COUPLING GENDER	Hex		THREAD SIZE(B)	DIAMETER		LENGTH		WEIGHT				
			mm	inch		mm	inch	mm	inch	kg	lbs			
6.3	QCA-6A-MG14	FEMALE	A	-	-	1/4"	D	-	-	C	-	-	-	
	QCA-6B-MG14	MALE	E	-	-	1/4"	F	-	-	H	-	-	-	
10	QCA-10A-MG38	FEMALE	A	24	0.94	3/8"	D	32	1.25	C	58	2.28	0.19	0.418
	QCA-10B-MG38	MALE	E	22	0.86	3/8"	F	17.23	0.67	H	40	1.57	0.09	0.198
12.5	QCA-12A-MG12	FEMALE	A	30	1.18	1/2"	D	38	1.49	C	69	2.71	0.29	0.638
	QCA-12B-MG12	MALE	E	27	1.06	1/2"	F	20.48	0.80	H	47	1.85	0.13	0.286
20	QCA-20A-MG34	FEMALE	A	38	1.49	3/4"	D	46.1	1.81	C	83	3.26	0.58	1.276
	QCA-20B-MG34	MALE	E	36	1.41	3/4"	F	29	1.14	H	56	2.20	0.27	0.594
25	QCA-25A-MG1	FEMALE	A	46	1.81	1"	D	54	2.12	C	99.2	3.90	0.7	1.54
	QCA-25B-MG1	MALE	E	41	1.61	1"	F	34.21	1.34	H	66	2.59	0.34	0.748
31.5	QCA-31A-MG114	FEMALE	A	55	2.16	1 1/4"	D	68	2.67	C	117.2	4.61	1.35	2.97
	QCA-31B-MG114	MALE	E	50	1.96	1 1/4"	F	44.9	1.74	H	75	2.95	0.55	1.21
40	QCA-40A-MG112	FEMALE	A	70	2.75	1 1/2"	D	83	3.26	C	134.2	5.28	2.7	5.94
	QCA-40B-MG112	MALE	E	60	2.36	1 1/2"	F	54.93	2.16	H	84	3.30	0.99	2.178
50	QCA-50A-MG2	FEMALE	A	80	3.14	2"	D	99	3.89	C	160.2	6.30	3.9	8.58
	QCA-50B-MG2	MALE	E	75	2.95	2"	F	65	2.55	H	97	3.81	1.5	3.3

ISO-8434-6

BODY SIZE	WORKING PRESSURE						BURST PRESSURE					
	COUPLE		FEMALE		MALE		COUPLE		FEMALE		MALE	
	MPa	PSI	MPa	PSI	MPa	PSI	MPa	PSI	MPa	PSI	MPa	PSI
6	-	-	-	-	-	-	-	-	-	-	-	-
10	31.5	4567	31.5	4567	31.5	4567	126	18270	126	18270	126	18270
12.5	25	3625	25	3625	25	3625	100	14500	100	14500	100	14500
19	25	3625	25	3625	25	3625	100	14500	100	14500	100	14500
25	20	2900	20	2900	20	2900	80	11600	80	11600	80	11600
31.5	20	2900	20	2900	20	2900	80	11600	80	11600	80	11600
40	16	2320	16	2320	16	2320	64	9280	64	9280	64	9280
50	10	1450	10	1450	10	1450	40	5800	40	5800	40	5800