

POPPET TYPE - QCA SERIES

METRIC (L)



[CLICK HERE FOR 3D SECTION](#)

TECHNICAL FEATURES AND OPTIONS

Locking Mechanism Locking Ball System	Flow Rate Up to 757 l / min	Material Carbon Steel Stainless Steel Brass
Working Temperature -20 °C / +90 °C	Interchange ISO 7241-A	How to Connect Push
Operating Pressure Up to 250 Bar	Available Threads BSP - NPT - Metric - SAE	Under Residual Pressure Connection: not Allowed Disconnection: not Allowed
Body Sizes ISO 6.3 - 50	Sealing Description NBR - FKM	Valve Type Poppet

MAIN APPLICATIONS

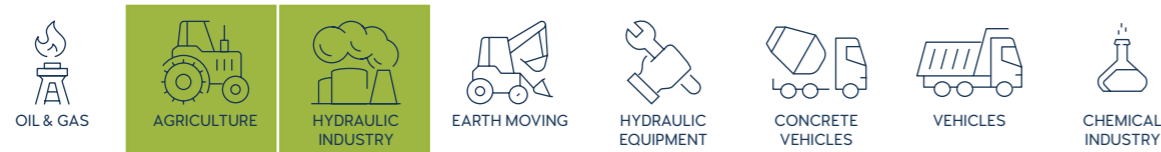

INFORMATION

- Do not connect or disconnect under residual pressure.
- Top quality elastomer seals provide maximum sealing.
- The external sealing ring ensures a solid connection and prevents disconnection due to vibration.
- The design prevents pressure drops and turbulences.
- Durable, safe, compact and easy to use design.
- Please clean the mating surfaces thoroughly before connecting, in order to prevent contaminants to enter into the system.
- Please make sure that the male and female parts are aligned properly to achieve full connection.

WARNING

- Connection and disconnection under dynamic pressure is not allowed.
- Connection and disconnection is not allowed when the temperature of the circulating fluid is above 80°C / 176°F.
- Make sure the system pressure is below the maximum working pressure.
- Please ensure that the OLEOCON product you have chosen is compatible with the temperature, material and pressure requirements of your system.
- Please contact OLEOCON technical support for any further questions.

TECHNICAL DRAWING

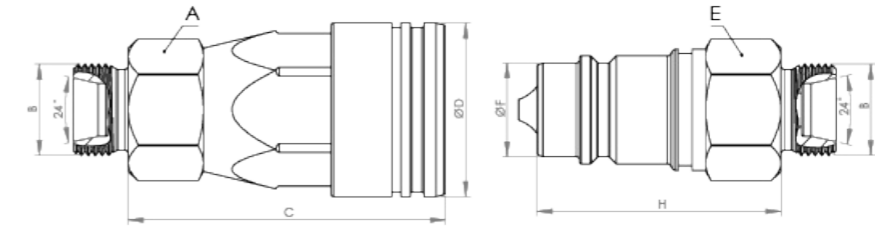

BODY SIZE	DESCRIPTION	COUPLING GENDER	Hex		THREAD SIZE (B)	DIAMETER		LENGTH		WEIGHT				
			mm	inch		mm	inch	mm	inch	kg	lbs			
6.3	QCA-6A-M6L	FEMALE	A	-	M12*1.5	D	-	-	C	-	-	-	-	
	QCA-6B-M6L	MALE	E	-	M12*1.5	F	-	-	H	-	-	-	-	
10	QCA-10A-M8L	FEMALE	A	24	0.94	M14*1.5	D	32	1.25	C	58	2.28	0.19	0.418
	QCA-10B-M8L	MALE	E	22	0.86	M14*1.5	F	17.23	0.67	H	40	1.57	0.09	0.198
	QCA-10A-M10L	FEMALE	A	24	0.94	M16*1.5	D	32	1.25	C	58	2.28	0.19	0.418
	QCA-10B-M10L	MALE	E	22	0.86	M16*1.5	F	17.23	0.67	H	40	1.57	0.09	0.198
	QCA-10A-M12L	FEMALE	A	24	0.94	M18*1.5	D	32	1.25	C	58	2.28	0.19	0.418
	QCA-10B-M12L	MALE	E	22	0.86	M18*1.5	F	17.23	0.67	H	40	1.57	0.09	0.198
12.5	QCA-12A-M12L	FEMALE	A	30	1.18	M18*1.5	D	38	1.49	C	69	2.71	0.29	0.638
	QCA-12B-M12L	MALE	E	27	1.06	M18*1.5	F	20.48	0.80	H	47	1.85	0.12	0.264
	QCA-12A-M15L	FEMALE	A	30	1.18	M22*1.5	D	38	1.49	C	69	2.71	0.29	0.638
	QCA-12B-M15L	MALE	E	27	1.06	M22*1.5	F	20.48	0.80	H	47	1.85	0.13	0.286
	QCA-12A-M18L	FEMALE	A	30	1.18	M26*1.5	D	38	1.49	C	69	2.71	0.3	0.66
	QCA-12B-M18L	MALE	E	27	1.06	M26*1.5	F	20.48	0.80	H	47	1.85	0.13	0.286
20	QCA-20A-M15L	FEMALE	A	38	1.49	M22*1.5	D	46.1	1.81	C	83	3.26	0.57	1.254
	QCA-20B-M15L	MALE	E	36	1.41	M22*1.5	F	29	1.14	H	56	2.20	0.26	0.572
	QCA-20A-M18L	FEMALE	A	38	1.49	M26*1.5	D	46.1	1.81	C	83	3.26	0.58	1.276
	QCA-20B-M18L	MALE	E	36	1.41	M26*1.5	F	29	1.14	H	56	2.20	0.27	0.594
	QCA-20A-M22L	FEMALE	A	38	1.49	M30*2	D	46.1	1.81	C	83	3.26	0.59	1.298
	QCA-20B-M22L	MALE	E	36	1.41	M30*2	F	29	1.14	H	56	2.20	0.27	0.594
25	QCA-25A-M18L	FEMALE	A	46	1.81	M26*1.5	D	54	2.12	C	99.2	3.90	0.68	1.496
	QCA-25B-M18L	MALE	E	41	1.61	M26*1.5	F	34.21	1.34	H	66	2.59	0.32	0.704
	QCA-25A-M22L	FEMALE	A	46	1.81	M30*2	D	54	2.12	C	99.2	3.90	0.69	1.518
	QCA-25B-M22L	MALE	E	41	1.61	M30*2	F	34.21	1.34	H	66	2.59	0.32	0.704
	QCA-25A-M28L	FEMALE	A	46	1.81	M36*2	D	54	2.12	C	99.2	3.90	0.69	1.518
	QCA-25B-M28L	MALE	E	41	1.61	M36*2	F	34.21	1.34	H	66	2.59	0.33	0.726

ISO-8434-1

BODY SIZE	WORKING PRESSURE						BURST PRESSURE					
	COUPLE		FEMALE		MALE		COUPLE		FEMALE		MALE	
	MPa	PSI	MPa	PSI	MPa	PSI	MPa	PSI	MPa	PSI	MPa	PSI
6	31.5	4567	31.5	4567	31.5	4567	126	18270	126	18270	126	18270
10	31.5	4567	31.5	4567	31.5	4567	126	18270	126	18270	126	18270
12.5	25	3625	25	3625	25	3625	100	14500	100	14500	100	14500
19	25	3625	25	3625	25	3625	100	14500	100	14500	100	14500
25	20	2900	20	2900	20	2900	80	11600	80	11600	80	11600
31.5	20	2900	20	2900	20	2900	80	11600	80	11600	80	11600
40	16	2320	16	2320	16	2320	64	9280	64	9280	64	9280
50	10	1450	10	1450	10	1450	40	5800	40	5800	40	5800

POPPET TYPE - QCA SERIES

METRIC (L)



[CLICK HERE FOR 3D SECTION](#)

TECHNICAL FEATURES AND OPTIONS

- Locking Mechanism**
Locking Ball System
- Flow Rate**
Up to 75 l / min
- Material**
Carbon Steel
Stainless Steel
Brass
- Working Temperature**
-20 °C / +90 °C
- Interchange**
ISO 7241-A
- How to Connect**
Push
- Operating Pressure**
Up to 250 Bar
- Available Threads**
BSP - NPT - Metric - SAE
- Under Residual Pressure**
Connction: not Allowed
Disconnection: not Allowed
- Body Sizes**
ISO 6.3 - 50
- Sealing Description**
NBR - FKM
- Valve Type**
Poppet

MAIN APPLICATIONS

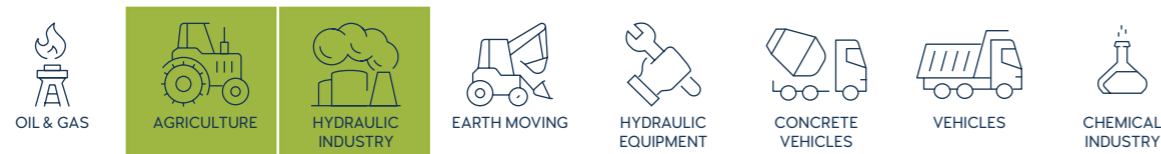

TECHNICAL DRAWING

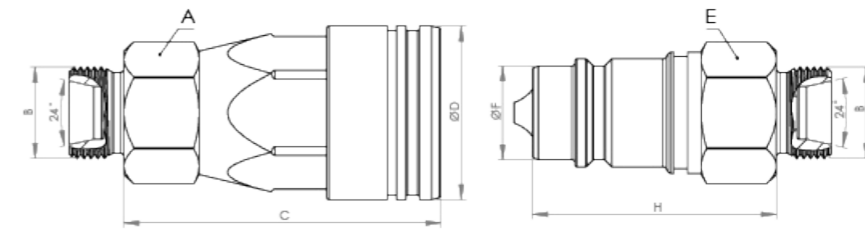

BODY SIZE	DESCRIPTION	COUPLING GENDER	Hex		THREAD SIZE(B)	DIAMETER		LENGTH		WEIGHT				
			mm	inch		mm	inch	mm	inch	kg	lbs			
31,5	QCA-31A-M22L	FEMALE	A	55	2,16	M30*2	D	68	2,67	C	1172	4,61	1,31	2,882
	QCA-31B-M22L	MALE	E	50	1,96	M30*2	F	44,9	44,9	H	75	2,95	0,51	1,122
	QCA-31A-M28L	FEMALE	A	55	2,16	M36*2	D	68	2,67	C	1172	4,61	1,31	2,882
	QCA-31B-M28L	MALE	E	50	1,96	M36*2	F	44,9	44,9	H	75	2,95	0,51	1,122
	QCA-31A-M35L	FEMALE	A	55	2,16	M45*2	D	68	2,67	C	1172	4,61	1,31	2,882
	QCA-31B-M35L	MALE	E	50	1,96	M45*2	F	44,9	44,9	H	75	2,95	0,51	1,122
40	QCA-40A-M35L	FEMALE	A	70	2,75	M45*2	D	83	3,26	C	1342	5,28	2,66	5,852
	QCA-40B-M35L	MALE	E	60	2,36	M45*2	F	54,93	2,16	H	84	3,30	0,96	2,112
	QCA-40A-M42L	FEMALE	A	70	2,75	M52*2	D	83	3,26	C	1342	5,28	2,66	5,852
50	QCA-40B-M42L	MALE	E	60	2,36	M52*2	F	54,93	2,16	H	84	3,30	0,96	2,112
	QCA-50A-M35L	FEMALE	A	80	3,14	M45*2	D	99	3,89	C	1602	6,30	3,89	8,558
	QCA-50B-M35L	MALE	E	75	2,95	M45*2	F	65	2,55	H	97	3,81	1,48	3,256
	QCA-50A-M35L	FEMALE	A	80	3,14	M52*2	D	99	3,89	C	1602	6,30	3,89	8,558
	QCA-50B-M35L	MALE	E	75	2,95	M52*2	F	65	2,55	H	97	3,81	1,48	3,256

ISO-8434-1

BODY SIZE	WORKING PRESSURE						BURST PRESSURE					
	COUPLE		FEMALE		MALE		COUPLE		FEMALE		MALE	
	MPa	PSI	MPa	PSI	MPa	PSI	MPa	PSI	MPa	PSI	MPa	PSI
6	31,5	4567	31,5	4567	31,5	4567	126	18270	126	18270	126	18270
10	31,5	4567	31,5	4567	31,5	4567	126	18270	126	18270	126	18270
12,5	25	3625	25	3625	25	3625	100	14500	100	14500	100	14500
19	25	3625	25	3625	25	3625	100	14500	100	14500	100	14500
25	20	2900	V20	2900	20	2900	80	11600	80	11600	80	11600
31,5	20	2900	20	2900	20	2900	80	11600	80	11600	80	11600
40	16	2320	16	2320	16	2320	64	9280	64	9280	64	9280
50	10	1450	10	1450	10	1450	40	5800	40	5800	40	5800

INFORMATION

- Do not connect or disconnect under residual pressure.
- Top quality elastomer seals provide maximum sealing.
- The external sealing ring ensures a solid connection and prevents disconnection due to vibration.
- The design prevents pressure drops and turbulences.
- Durable, safe, compact and easy to use design.
- Please clean the mating surfaces thoroughly before connecting, in order to prevent contaminants to enter into the system.
- Please make sure that the male and female parts are aligned properly to achieve full connection.

WARNING

- Connection and disconnection under dynamic pressure is not allowed.
- Connection and disconnection is not allowed when the temperature of the circulating fluid is above 80°C / 176°F.
- Make sure the system pressure is below the maximum working pressure.
- Please ensure that the OLEOCON product you have chosen is compatible with the temperature, material and pressure requirements of your system.
- Please contact OLEOCON technical support for any further questions.

POPPET TYPE - QCA SERIES

METRIC (S)



[CLICK HERE FOR 3D SECTION](#)

TECHNICAL FEATURES AND OPTIONS

Locking Mechanism Locking Ball System	Flow Rate Up to 757 l / min	Material Carbon Steel Stainless Steel Brass
Working Temperature -20 °C / +90 °C	Interchange ISO 7241-A	How to Connect Push
Operating Pressure Up to 250 Bar	Available Threads BSP - NPT - Metric - SAE	Under Residual Pressure Connction: not Allowed Disconnection: not Allowed
Body Sizes ISO 6.3 - 50	Sealing Description NBR - FKM	Valve Type Poppet

MAIN APPLICATIONS

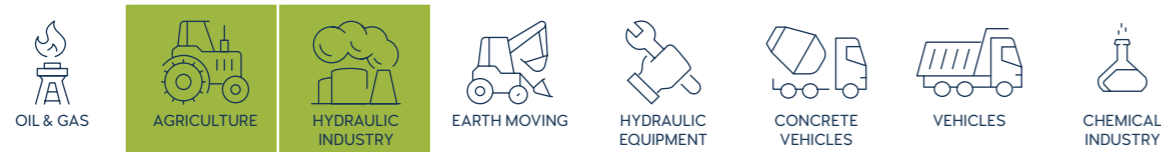

INFORMATION

- Do not connect or disconnect under residual pressure.
- Top quality elastomer seals provide maximum sealing.
- The external sealing ring ensures a solid connection and prevents disconnection due to vibration.
- The design prevents pressure drops and turbulences.
- Durable, safe, compact and easy to use design.
- Please clean the mating surfaces thoroughly before connecting, in order to prevent contaminants to enter into the system.
- Please make sure that the male and female parts are aligned properly to achive full connection.

WARNING

- Connection and disconnection under dynamic pressure is not allowed.
- Connection and disconnection is not allowed when the temperature of the circulating fluid is above 80°C / 176°F.
- Make sure the system pressure is below the maximum working pressure.
- Please ensure that the OLEOCON product you have chosen is compatible with the temperature , material and pressure requirements of your system.
- Please contact OLEOCON technical support for any further questions.

TECHNICAL DRAWING

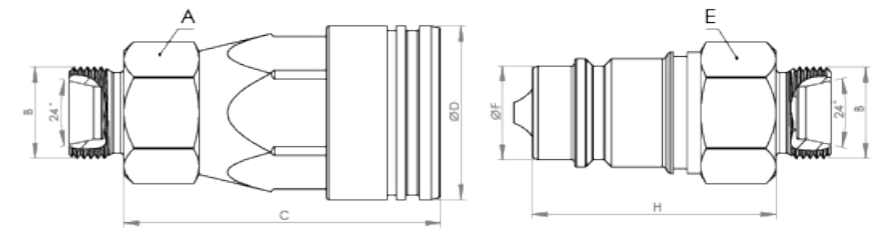

BODY SIZE	DESCRIPTION	COUPLING GENDER	Hex		THREAD SIZE(B)	DIAMETER		LENGTH		WEIGHT				
			mm	inch		mm	inch	mm	inch	kg	lbs			
6.3	QCA-6A-M6S	FEMALE	A	-	M14*1.5	D	-	C	-	-	-	-		
	QCA-6B-M6S	MALE	E	-	M14*1.5	F	-	H	-	-	-	-		
10	QCA-10A-M8S	FEMALE	A	24	0.94	M16*1.5	D	32	1.25	C	58	2.28	0.2	0.44
	QCA-10B-M8S	MALE	E	22	0.86	M16*1.5	F	17.23	0.67	H	40	1.57	0.09	0.198
	QCA-10A-M10S	FEMALE	A	24	0.94	M18*1.5	D	32	1.25	C	58	2.28	0.2	0.44
	QCA-10B-M10S	MALE	E	22	0.86	M18*1.5	F	17.23	0.67	H	40	1.57	0.09	0.198
	QCA-10A-M12S	FEMALE	A	24	0.94	M20*1.5	D	32	1.25	C	58	2.28	0.21	0.462
	QCA-10B-M12S	MALE	E	22	0.86	M20*1.5	F	17.23	0.67	H	40	1.57	0.1	0.22
12.5	QCA-12A-M10S	FEMALE	A	30	1.18	M18*1.5	D	38	1.49	C	69	2.71	0.29	0.638
	QCA-12B-M10S	MALE	E	27	1.06	M18*1.5	F	20.48	0.80	H	47	1.85	0.13	0.286
	QCA-12A-M12S	FEMALE	A	30	1.18	M20*1.5	D	38	1.49	C	69	2.71	0.3	0.66
	QCA-12B-M12S	MALE	E	27	1.06	M20*1.5	F	20.48	0.80	H	47	1.85	0.13	0.286
	QCA-12A-M16S	FEMALE	A	30	1.18	M24*1.5	D	38	1.49	C	69	2.71	0.31	0.682
	QCA-12B-M16S	MALE	E	27	1.06	M24*1.5	F	20.48	0.80	H	47	1.85	0.14	0.308
20	QCA-20A-M12S	FEMALE	A	38	1.49	M20*1.5	D	46.1	1.81	C	83	3.26	0.57	1.254
	QCA-20B-M12S	MALE	E	36	1.41	M20*1.5	F	29	1.14	H	56	2.20	0.27	0.594
	QCA-20A-M16S	FEMALE	A	38	1.49	M24*1.5	D	46.1	1.81	C	83	3.26	0.58	1.276
	QCA-20B-M16S	MALE	E	36	1.41	M24*1.5	F	29	1.14	H	56	2.20	0.27	0.594
	QCA-20A-M20S	FEMALE	A	38	1.49	M30*2	D	46.1	1.81	C	83	3.26	0.59	1.298
	QCA-20B-M20S	MALE	E	36	1.41	M30*2	F	29	1.14	H	56	2.20	0.28	0.616

ISO-8434-1

BODY SIZE	WORKING PRESSURE						BURST PRESSURE					
	COUPLE		FEMALE		MALE		COUPLE		FEMALE		MALE	
	MPa	PSI	MPa	PSI	MPa	PSI	MPa	PSI	MPa	PSI	MPa	PSI
6	31.5	4567	31.5	4567	31.5	4567	126	18270	126	18270	126	18270
10	31.5	4567	31.5	4567	31.5	4567	126	18270	126	18270	126	18270
12.5	25	3625	25	3625	25	3625	100	14500	100	14500	100	14500
19	25	3625	25	3625	25	3625	100	14500	100	14500	100	14500
25	20	2900	20	2900	20	2900	80	11600	80	11600	80	11600
31.5	20	2900	20	2900	20	2900	80	11600	80	11600	80	11600
40	16	2320	16	2320	16	2320	64	9280	64	9280	64	9280
50	10	1450	10	1450	10	1450	40	5800	40	5800	40	5800

POPPET TYPE - QCA SERIES

METRIC (S)



[CLICK HERE FOR 3D SECTION](#)

TECHNICAL FEATURES AND OPTIONS

Locking Mechanism Locking Ball System	Flow Rate Up to 757 l / min	Material Carbon Steel Stainless Steel Brass
Working Temperature -20 °C / +90 °C	Interchange ISO 7241-A	How to Connect Push
Operating Pressure Up to 250 Bar	Available Threads BSP - NPT - Metric - SAE	Under Residual Pressure Connection: not Allowed Disconnection: not Allowed
Body Sizes ISO 6.3 - 50	Sealing Description NBR - FKM	Valve Type Poppet

MAIN APPLICATIONS

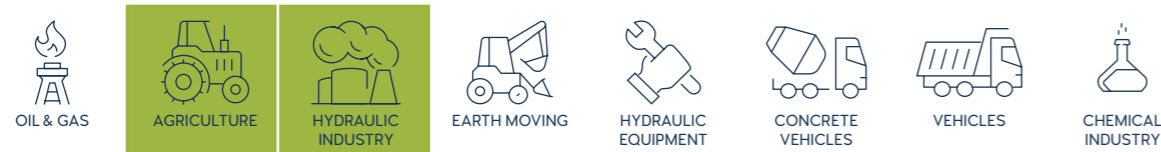

INFORMATION

- Do not connect or disconnect under residual pressure.
- Top quality elastomer seals provide maximum sealing.
- The external sealing ring ensures a solid connection and prevents disconnection due to vibration.
- The design prevents pressure drops and turbulences.
- Durable, safe, compact and easy to use design.
- Please clean the mating surfaces thoroughly before connecting, in order to prevent contaminants to enter into the system.
- Please make sure that the male and female parts are aligned properly to achieve full connection.

WARNING

- Connection and disconnection under dynamic pressure is not allowed.
- Connection and disconnection is not allowed when the temperature of the circulating fluid is above 80°C / 176°F.
- Make sure the system pressure is below the maximum working pressure.
- Please ensure that the OLEOCON product you have chosen is compatible with the temperature, material and pressure requirements of your system.
- Please contact OLEOCON technical support for any further questions.

TECHNICAL DRAWING

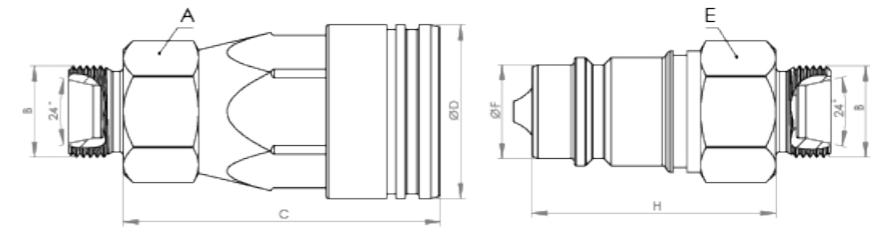

BODY SIZE	DESCRIPTION	COUPLING GENDER	Hex		THREAD SIZE(B)	DIAMETER		LENGTH		WEIGHT				
			mm	inch		mm	inch	mm	inch	kg	lbs			
25	QCA-25A-M16S	FEMALE	A	46	1.81	M24*1.5	D	54	2.12	C	99.2	3.90	0.68	1.496
	QCA-25B-M16S	MALE	E	41	1.61	M24*1.5	F	34.21	1.34	H	66	2.59	0.33	0.726
	QCA-25A-M20S	FEMALE	A	46	1.81	M30*2	D	54	2.12	C	99.2	3.90	0.7	1.54
	QCA-25B-M20S	MALE	E	41	1.61	M30*2	F	34.21	1.34	H	66	2.59	0.34	0.748
	QCA-25A-M25S	FEMALE	A	46	1.81	M36*2	D	54	2.12	C	99.2	3.90	0.71	1.562
	QCA-25B-M25S	MALE	E	41	1.61	M36*2	F	34.21	1.34	H	66	2.59	0.36	0.792
31,5	QCA-31A-M20S	FEMALE	A	55	2.16	M30*2	D	68	2.67	C	117.2	4.61	1.32	2.904
	QCA-31B-M20S	MALE	E	50	1.96	M30*2	F	44.9	44.9	H	75	2.95	0.52	1.144
	QCA-31A-M25S	FEMALE	A	55	2.16	M36*2	D	68	2.67	C	117.2	4.61	1.33	2.926
	QCA-31B-M25S	MALE	E	50	1.96	M36*2	F	44.9	44.9	H	75	2.95	0.52	1.144
	QCA-31A-M30S	FEMALE	A	55	2.16	M42*2	D	68	2.67	C	117.2	4.61	1.34	2.948
	QCA-31B-M30S	MALE	E	50	1.96	M42*2	F	44.9	44.9	H	75	2.95	0.52	1.144
40	QCA-40A-M30S	FEMALE	A	70	2.75	M42*2	D	83	3.26	C	134.2	5.28	2.65	5.83
	QCA-40B-M30S	MALE	E	60	2.36	M42*2	F	54.93	2.16	H	84	3.30	0.97	2.134
	QCA-40A-M38S	FEMALE	A	70	2.75	M52*2	D	83	3.26	C	134.2	5.28	2.66	5.852
50	QCA-40B-M38S	MALE	E	60	2.36	M52*2	F	54.93	2.16	H	84	3.30	0.97	2.134
	QCA-50A-M30S	FEMALE	A	80	3.14	M42*2	D	99	3.89	C	160.2	6.30	3.9	8.58
	QCA-50B-M30S	MALE	E	75	2.95	M42*2	F	65	2.55	H	97	3.81	1.49	3.278
	QCA-50A-M38S	FEMALE	A	80	3.14	M52*2	D	99	3.89	C	160.2	6.30	3.91	8.602
	QCA-50B-M38S	MALE	E	75	2.95	M52*2	F	65	2.55	H	97	3.81	1.5	3.3

ISO-8434-1

BODY SIZE	WORKING PRESSURE						BURST PRESSURE					
	COUPLE		FEMALE		MALE		COUPLE		FEMALE		MALE	
	MPa	PSI	MPa	PSI	MPa	PSI	MPa	PSI	MPa	PSI	MPa	PSI
6	31.5	4567	31.5	4567	31.5	4567	126	18270	126	18270	126	18270
10	31.5	4567	31.5	4567	31.5	4567	126	18270	126	18270	126	18270
12.5	25	3625	25	3625	25	3625	100	14500	100	14500	100	14500
19	25	3625	25	3625	25	3625	100	14500	100	14500	100	14500
25	20	2900	20	2900	20	2900	80	11600	80	11600	80	11600
31,5	20	2900	20	2900	20	2900	80	11600	80	11600	80	11600
40	16	2320	16	2320	16	2320	64	9280	64	9280	64	9280
50	10	1450	10	1450	10	1450	40	5800	40	5800	40	5800