

POPPET TYPE - QCA SERIES

METRIC (L) BULKHEAD

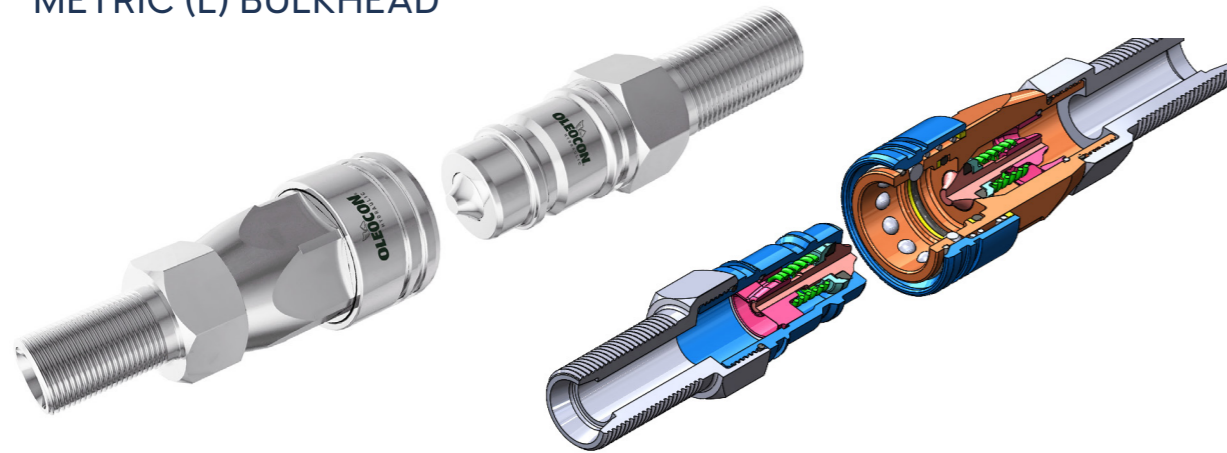

[CLICK HERE FOR 3D SECTION](#)

TECHNICAL FEATURES AND OPTIONS

- Locking Mechanism**
Locking Ball System
- Flow Rate**
Up to 757 l / min
- Material**
Carbon Steel
Stainless Steel
Brass
- Working Temperature**
-20 °C / +90 °C
- Interchange**
ISO 7241-A
- How to Connect**
Push
- Operating Pressure**
Up to 250 Bar
- Available Threads**
BSP - NPT - Metric - SAE
- Under Residual Pressure**
Connction: not Allowed
Disconnection: not Allowed
- Body Sizes**
ISO 6.3 - 50
- Sealing Description**
NBR - FKM
- Valve Type**
Poppet

TECHNICAL DRAWING

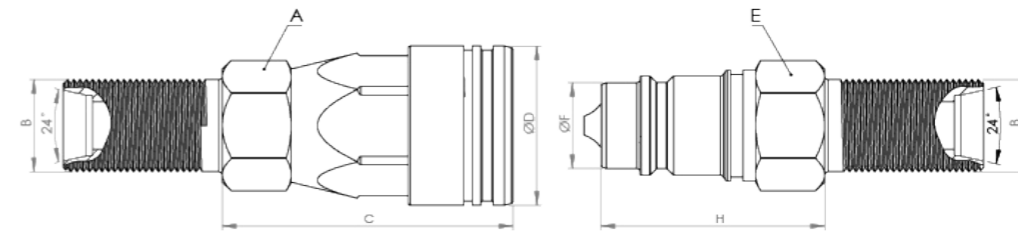

BODY SIZE	DESCRIPTION	COUPLING GENDER	Hex		THREAD SIZE(B)	DIAMETER		LENGTH		WEIGHT				
			mm	inch		mm	inch	mm	inch	kg	lbs			
6.3	QCA-6A-M6L-BH	FEMALE	A	-	M12*1.5	D	-	-	C	-	-	-	-	
	QCA-6B-M6L-BH	MALE	E	-	M12*1.5	F	-	-	H	-	-	-	-	
10	QCA-10A-M8L-BH	FEMALE	A	24	0.94	M14*1.5	D	32	1.25	C	58	2.28	0.21	0.462
	QCA-10B-M8L-BH	MALE	E	22	0.86	M14*1.5	F	17.23	0.67	H	40	1.57	0.11	0.242
	QCA-10A-M10L-BH	FEMALE	A	24	0.94	M16*1.5	D	32	1.25	C	58	2.28	0.22	0.484
	QCA-10B-M10L-BH	MALE	E	22	0.86	M16*1.5	F	17.23	0.67	H	40	1.57	0.11	0.242
	QCA-10A-M12L-BH	FEMALE	A	24	0.94	M18*1.5	D	32	1.25	C	58	2.28	0.23	0.506
	QCA-10B-M12L-BH	MALE	E	22	0.86	M18*1.5	F	17.23	0.67	H	40	1.57	0.12	0.264
12.5	QCA-12A-M12L-BH	FEMALE	A	30	1.18	M18*1.5	D	38	1.49	C	69	2.71	0.32	0.704
	QCA-12B-M12L-BH	MALE	E	27	1.06	M18*1.5	F	20.48	0.80	H	47	1.85	0.15	0.33
	QCA-12A-M15L-BH	FEMALE	A	30	1.18	M22*1.5	D	38	1.49	C	69	2.71	0.34	0.748
	QCA-12B-M15L-BH	MALE	E	27	1.06	M22*1.5	F	20.48	0.80	H	47	1.85	0.18	0.396
	QCA-12A-M18L-BH	FEMALE	A	30	1.18	M26*1.5	D	38	1.49	C	69	2.71	0.39	0.858
	QCA-12B-M18L-BH	MALE	E	27	1.06	M26*1.5	F	20.48	0.80	H	47	1.85	0.22	0.484
20	QCA-20A-M15L-BH	FEMALE	A	38	1.49	M22*1.5	D	46.1	1.81	C	83	3.26	0.62	1.364
	QCA-20B-M15L-BH	MALE	E	36	1.41	M22*1.5	F	29	1.14	H	56	2.20	0.32	0.704
	QCA-20A-M18L-BH	FEMALE	A	38	1.49	M26*1.5	D	46.1	1.81	C	83	3.26	0.65	1.43
	QCA-20B-M18L-BH	MALE	E	36	1.41	M26*1.5	F	29	1.14	H	56	2.20	0.34	0.748
	QCA-20A-M22L-BH	FEMALE	A	38	1.49	M30*2	D	46.1	1.81	C	83	3.26	0.66	1.452
	QCA-20B-M22L-BH	MALE	E	36	1.41	M30*2	F	29	1.14	H	56	2.20	0.36	0.792

ISO 8434-1

MAIN APPLICATIONS

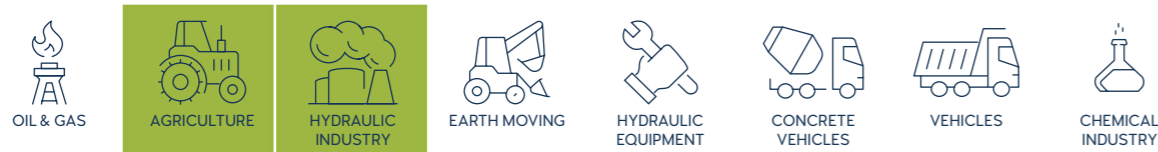

INFORMATION

- Do not connect or disconnect under residual pressure.
- Top quality elastomer seals provide maximum sealing.
- The external sealing ring ensures a solid connection and prevents disconnection due to vibration.
- The design prevents pressure drops and turbulences.
- Durable, safe, compact and easy to use design.
- Please clean the mating surfaces thoroughly before connecting, in order to prevent contaminants to enter into the system.
- Please make sure that the male and female parts are aligned properly to achieve full connection.

WARNING

- Connection and disconnection under dynamic pressure is not allowed.
- Connection and disconnection is not allowed when the temperature of the circulating fluid is above 80°C / 176°F.
- Make sure the system pressure is below the maximum working pressure.
- Please ensure that the OLEOCON product you have chosen is compatible with the temperature, material and pressure requirements of your system.
- Please contact OLEOCON technical support for any further questions.

POPPET TYPE - QCA SERIES

METRIC (L) BULKHEAD



[CLICK HERE FOR 3D SECTION](#)

TECHNICAL FEATURES AND OPTIONS

Locking Mechanism Locking Ball System	Flow Rate Up to 757 l / min	Material Carbon Steel Stainless Steel Brass
Working Temperature -20 °C / +90 °C	Interchange ISO 7241-A	How to Connect Push
Operating Pressure Up to 250 Bar	Available Threads BSP - NPT - Metric - SAE	Under Residual Pressure Connction: not Allowed Disconnection: not Allowed
Body Sizes ISO 6.3 - 50	Sealing Description NBR - FKM	Valve Type Poppet

TECHNICAL DRAWING

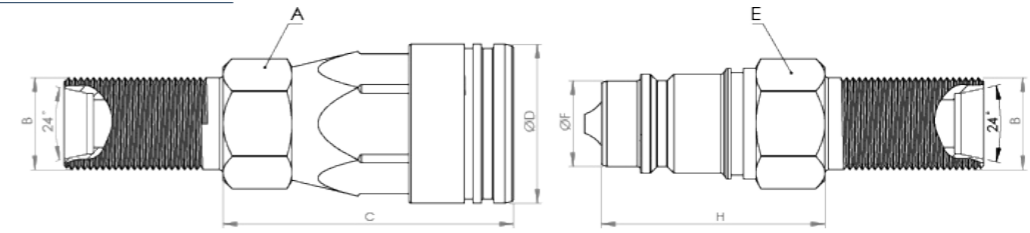

BODY SIZE	DESCRIPTION	COUPLING GENDER	Hex		THREAD SIZE(B)	DIAMETER		LENGTH		WEIGHT				
			mm	inch		mm	inch	mm	inch	kg	lbs			
25	QCA-25A-M18L-BH	FEMALE	A	46	1.81	M26*1.5	D	54	2.12	C	99.2	3.90	0.75	1.65
	QCA-25B-M18L-BH	MALE	E	41	1.61	M26*1.5	F	34.21	1.34	H	66	2.59	0.4	0.88
	QCA-25A-M22L-BH	FEMALE	A	46	1.81	M30*2	D	54	2.12	C	99.2	3.90	0.77	1.694
	QCA-25B-M22L-BH	MALE	E	41	1.61	M30*2	F	34.21	1.34	H	66	2.59	0.41	0.902
	QCA-25A-M28L-BH	FEMALE	A	46	1.81	M36*2	D	54	2.12	C	99.2	3.90	0.8	1.76
	QCA-25B-M28L-BH	MALE	E	41	1.61	M36*2	F	34.21	1.34	H	66	2.59	0.44	0.968
31.5	QCA-31A-M22L-BH	FEMALE	A	55	2.16	M30*2	D	68	2.67	C	117.2	4.61	1.35	2.97
	QCA-31B-M22L-BH	MALE	E	50	1.96	M30*2	F	44.9	44.9	H	75	2.95	0.52	1.144
	QCA-31A-M28L-BH	FEMALE	A	55	2.16	M36*2	D	68	2.67	C	117.2	4.61	1.36	2.992
	QCA-31B-M28L-BH	MALE	E	50	1.96	M36*2	F	44.9	44.9	H	75	2.95	0.53	1.166
	QCA-31A-M35L-BH	FEMALE	A	55	2.16	M45*2	D	68	2.67	C	117.2	4.61	1.37	3.014
	QCA-31B-M35L-BH	MALE	E	50	1.96	M45*2	F	44.9	44.9	H	75	2.95	0.53	1.166
40	QCA-40A-M35L-BH	FEMALE	A	70	2.75	M45*2	D	83	3.26	C	134.2	5.28	2.68	5.896
	QCA-40B-M35L-BH	MALE	E	60	2.36	M45*2	F	54.93	2.16	H	84	3.30	0.98	2.156
	QCA-40A-M42L-BH	FEMALE	A	70	2.75	M52*2	D	83	3.26	C	134.2	5.28	2.7	5.94
50	QCA-40B-M42L-BH	MALE	E	60	2.36	M52*2	F	54.93	2.16	H	84	3.30	0.99	2.178
	QCA-50A-M35L-BH	FEMALE	A	80	3.14	M45*2	D	99	3.89	C	160.2	6.30	3.9	8.58
	QCA-50B-M35L-BH	MALE	E	75	2.95	M45*2	F	65	2.55	H	97	3.81	1.5	3.3
	QCA-50A-M35L-BH	FEMALE	A	80	3.14	M52*2	D	99	3.89	C	160.2	6.30	3.91	8.602
	QCA-50B-M35L-BH	MALE	E	75	2.95	M52*2	F	65	2.55	H	97	3.81	1.51	3.322

ISO 8434-1

MAIN APPLICATIONS

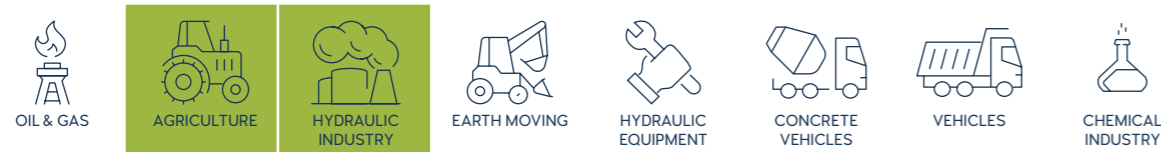

INFORMATION

- Do not connect or disconnect under residual pressure.
- Top quality elastomer seals provide maximum sealing.
- The external sealing ring ensures a solid connection and prevents disconnection due to vibration.
- The design prevents pressure drops and turbulences.
- Durable, safe, compact and easy to use design.
- Please clean the mating surfaces thoroughly before connecting, in order to prevent contaminants to enter into the system.
- Please make sure that the male and female parts are aligned properly to achieve full connection.

WARNING

- Connection and disconnection under dynamic pressure is not allowed.
- Connection and disconnection is not allowed when the temperature of the circulating fluid is above 80°C / 176°F.
- Make sure the system pressure is below the maximum working pressure.
- Please ensure that the OLEOCON product you have chosen is compatible with the temperature, material and pressure requirements of your system.
- Please contact OLEOCON technical support for any further questions.

POPPET TYPE - QCA SERIES

METRIC (S) BULKHEAD



[CLICK HERE FOR 3D SECTION](#)

TECHNICAL FEATURES AND OPTIONS

- Locking Mechanism**
Locking Ball System
- Flow Rate**
Up to 757 l / min
- Material**
Carbon Steel
Stainless Steel
Brass
- Working Temperature**
-20 °C / +90 °C
- Interchange**
ISO 7241-A
- How to Connect**
Push
- Operating Pressure**
Up to 250 Bar
- Available Threads**
BSP - NPT - Metric - SAE
- Under Residual Pressure**
Connction: not Allowed
Disconnection: not Allowed
- Body Sizes**
ISO 6.3 - 50
- Sealing Description**
NBR - FKM
- Valve Type**
Poppet

TECHNICAL DRAWING

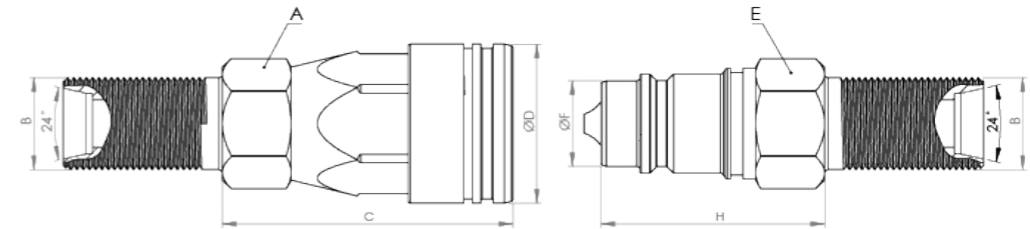

BODY SIZE	DESCRIPTION	COUPLING GENDER	Hex		THREAD SIZE(B)	DIAMETER		LENGTH		WEIGHT				
			mm	inch		mm	inch	mm	inch	kg	lbs			
6.3	QCA-6A-M6S-BH	FEMALE	A	-	M14*1.5	D	-	-	C	-	-	-	-	
	QCA-6B-M6S-BH	MALE	E	-	M14*1.5	F	-	-	H	-	-	-	-	
10	QCA-10A-M8S-BH	FEMALE	A	24	0.94	M16*1.5	D	32	1.25	C	58	2.28	0.23	0.506
	QCA-10B-M8S-BH	MALE	E	22	0.86	M16*1.5	F	17.23	0.67	H	40	1.57	0.13	0.286
	QCA-10A-M10S-BH	FEMALE	A	24	0.94	M18*1.5	D	32	1.25	C	58	2.28	0.24	0.528
	QCA-10B-M10S-BH	MALE	E	22	0.86	M18*1.5	F	17.23	0.67	H	40	1.57	0.13	0.286
	QCA-10A-M12S-BH	FEMALE	A	24	0.94	M20*1.5	D	32	1.25	C	58	2.28	0.25	0.55
	QCA-10B-M12S-BH	MALE	E	22	0.86	M20*1.5	F	17.23	0.67	H	40	1.57	0.15	0.33
12.5	QCA-12A-M10S-BH	FEMALE	A	30	1.18	M18*1.5	D	38	1.49	C	69	2.71	0.33	0.726
	QCA-12B-M10S-BH	MALE	E	27	1.06	M18*1.5	F	20.48	0.80	H	47	1.85	0.16	0.352
	QCA-12A-M12S-BH	FEMALE	A	30	1.18	M20*1.5	D	38	1.49	C	69	2.71	0.34	0.748
	QCA-12B-M12S-BH	MALE	E	27	1.06	M20*1.5	F	20.48	0.80	H	47	1.85	0.18	0.396
	QCA-12A-M16S-BH	FEMALE	A	30	1.18	M24*1.5	D	38	1.49	C	69	2.71	0.38	0.836
	QCA-12B-M16S-BH	MALE	E	27	1.06	M24*1.5	F	20.48	0.80	H	47	1.85	0.22	0.484
20	QCA-20A-M12S-BH	FEMALE	A	38	1.49	M20*1.5	D	46.1	1.81	C	83	3.26	0.62	1.364
	QCA-20B-M12S-BH	MALE	E	36	1.41	M20*1.5	F	29	1.14	H	56	2.20	0.32	0.704
	QCA-20A-M16S-BH	FEMALE	A	38	1.49	M24*1.5	D	46.1	1.81	C	83	3.26	0.65	1.43
	QCA-20B-M16S-BH	MALE	E	36	1.41	M24*1.5	F	29	1.14	H	56	2.20	0.34	0.748
	QCA-20A-M20S-BH	FEMALE	A	38	1.49	M30*2	D	46.1	1.81	C	83	3.26	0.7	1.54
	QCA-20B-M20S-BH	MALE	E	36	1.41	M30*2	F	29	1.14	H	56	2.20	0.39	0.858

ISO 8434-1

MAIN APPLICATIONS

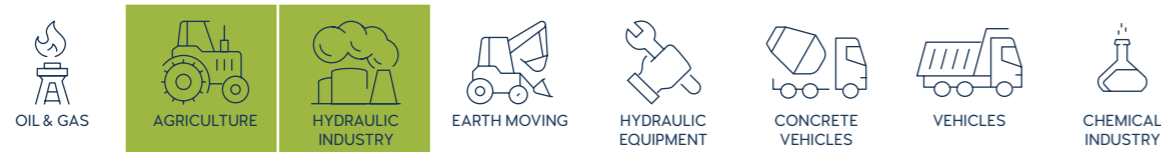

INFORMATION

- Do not connect or disconnect under residual pressure.
- Top quality elastomer seals provide maximum sealing.
- The external sealing ring ensures a solid connection and prevents disconnection due to vibration.
- The design prevents pressure drops and turbulences.
- Durable, safe, compact and easy to use design.
- Please clean the mating surfaces thoroughly before connecting, in order to prevent contaminants to enter into the system.
- Please make sure that the male and female parts are aligned properly to achieve full connection.

WARNING

- Connection and disconnection under dynamic pressure is not allowed.
- Connection and disconnection is not allowed when the temperature of the circulating fluid is above 80°C / 176°F.
- Make sure the system pressure is below the maximum working pressure.
- Please ensure that the OLEOCON product you have chosen is compatible with the temperature, material and pressure requirements of your system.
- Please contact OLEOCON technical support for any further questions.

POPPET TYPE - QCA SERIES

METRIC (S) BULKHEAD



[CLICK HERE FOR 3D SECTION](#)

TECHNICAL FEATURES AND OPTIONS

Locking Mechanism Locking Ball System	Flow Rate Up to 75 l / min	Material Carbon Steel Stainless Steel Brass
Working Temperature -20 °C / +90 °C	Interchange ISO 7241-A	How to Connect Push
Operating Pressure Up to 250 Bar	Available Threads BSP - NPT - Metric - SAE	Under Residual Pressure Connction: not Allowed Disconnection: not Allowed
Body Sizes ISO 6.3 - 50	Sealing Description NBR - FKM	Valve Type Poppet

TECHNICAL DRAWING

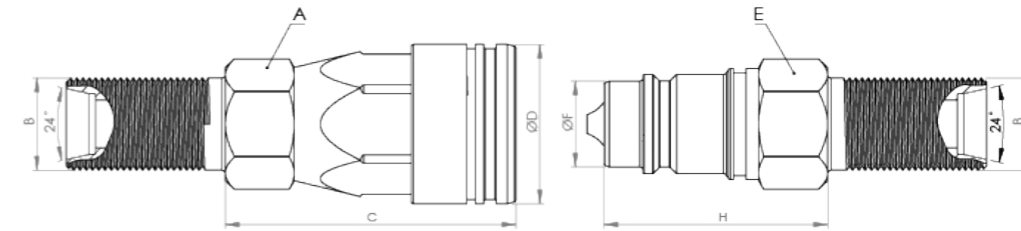

BODY SIZE	DESCRIPTION	COUPLING GENDER	Hex		THREAD SIZE(B)	DIAMETER		LENGTH		WEIGHT				
			mm	inch		mm	inch	mm	inch	kg	lbs			
25	QCA-25A-M16S-BH	FEMALE	A	46	1.81	M24*1.5	D	54	2.12	C	99.2	3.90	0.75	1.65
	QCA-25B-M16S-BH	MALE	E	41	1.61	M24*1.5	F	34.21	1.34	H	66	2.59	0.4	0.88
	QCA-25A-M20S-BH	FEMALE	A	46	1.81	M30*2	D	54	2.12	C	99.2	3.90	0.8	1.76
	QCA-25B-M20S-BH	MALE	E	41	1.61	M30*2	F	34.21	1.34	H	66	2.59	0.45	0.99
	QCA-25A-M25S-BH	FEMALE	A	46	1.81	M36*2	D	54	2.12	C	99.2	3.90	0.87	1.914
	QCA-25B-M25S-BH	MALE	E	41	1.61	M36*2	F	34.21	1.34	H	66	2.59	0.51	1.122
31.5	QCA-31A-M20S-BH	FEMALE	A	55	2.16	M30*2	D	68	2.67	C	117.2	4.61	1.3	2.86
	QCA-31B-M20S-BH	MALE	E	50	1.96	M30*2	F	44.9	44.9	H	75	2.95	0.52	1.144
	QCA-31A-M25S-BH	FEMALE	A	55	2.16	M36*2	D	68	2.67	C	117.2	4.61	1.31	2.882
	QCA-31B-M25S-BH	MALE	E	50	1.96	M36*2	F	44.9	44.9	H	75	2.95	0.52	1.144
	QCA-31A-M30S-BH	FEMALE	A	55	2.16	M42*2	D	68	2.67	C	117.2	4.61	1.32	2.904
	QCA-31B-M30S-BH	MALE	E	50	1.96	M42*2	F	44.9	44.9	H	75	2.95	0.53	1.166
40	QCA-40A-M30S-BH	FEMALE	A	70	2.75	M42*2	D	83	3.26	C	134.2	5.28	2.68	5.896
	QCA-40B-M30S-BH	MALE	E	60	2.36	M42*2	F	54.93	2.16	H	84	3.30	0.97	2.134
	QCA-40A-M38S-BH	FEMALE	A	70	2.75	M52*2	D	83	3.26	C	134.2	5.28	2.68	5.896
	QCA-40B-M38S-BH	MALE	E	60	2.36	M52*2	F	54.93	2.16	H	84	3.30	0.98	2.156
50	QCA-50A-M30S-BH	FEMALE	A	80	3.14	M42*2	D	99	3.89	C	160.2	6.30	3.9	8.58
	QCA-50B-M30S-BH	MALE	E	75	2.95	M42*2	F	65	2.55	H	97	3.81	1.5	3.3
	QCA-50A-M38S-BH	FEMALE	A	80	3.14	M52*2	D	99	3.89	C	160.2	6.30	2.91	6.402
	QCA-50B-M38S-BH	MALE	E	75	2.95	M52*2	F	65	2.55	H	97	3.81	1.51	3.322

ISO 8434-1

MAIN APPLICATIONS

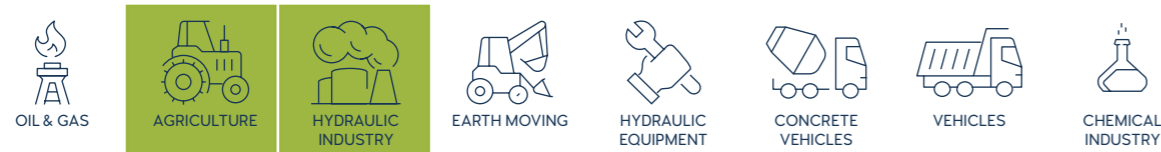

INFORMATION

- Do not connect or disconnect under residual pressure.
- Top quality elastomer seals provide maximum sealing.
- The external sealing ring ensures a solid connection and prevents disconnection due to vibration.
- The design prevents pressure drops and turbulences.
- Durable, safe, compact and easy to use design.
- Please clean the mating surfaces thoroughly before connecting, in order to prevent contaminants to enter into the system.
- Please make sure that the male and female parts are aligned properly to achieve full connection.

WARNING

- Connection and disconnection under dynamic pressure is not allowed.
- Connection and disconnection is not allowed when the temperature of the circulating fluid is above 80°C / 176°F.
- Make sure the system pressure is below the maximum working pressure.
- Please ensure that the OLEOCON product you have chosen is compatible with the temperature, material and pressure requirements of your system.
- Please contact OLEOCON technical support for any further questions.