

PUSH PULL

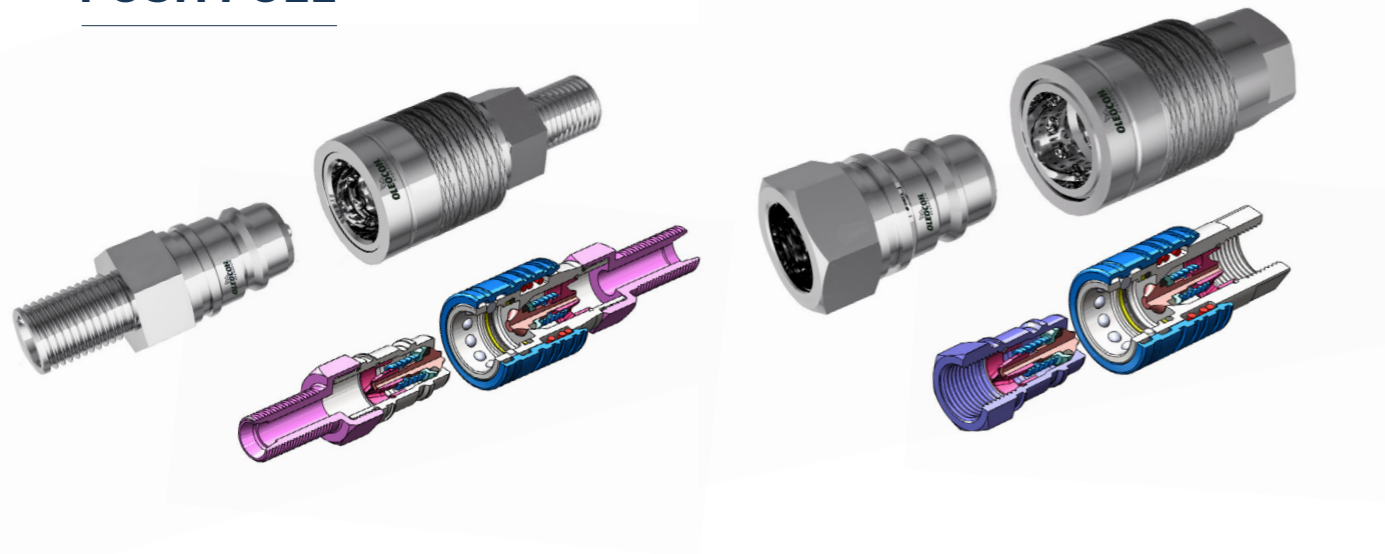

[CLICK HERE FOR 3D SECTION](#)

[CLICK HERE FOR 3D SECTION](#)

TECHNICAL FEATURES AND OPTIONS

- Locking Mechanism**
Locking Ball System
- Flow Rate**
Up to 45 l / min
- Material**
Carbon Steel
Stainless Steel
Brass
- Working Temperature**
-20 °C / +100 °C
- Interchange**
ISO 7241-A
- How to Connect**
Push
- Operating Pressure**
Up to 250 Bar
- Available Threads**
BSP - Metric
- Under Residual Pressure**
Connetion: not Allowed
Disconnection: not Allowed
- Body Sizes**
ISO 12.5
- Sealing Description**
NBR - FKM
- Valve Type**
Popet

MAIN APPLICATIONS

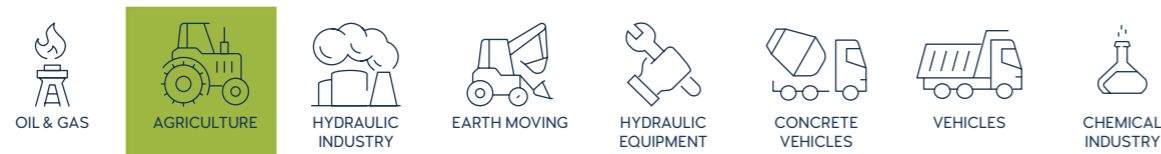

INFORMATION

- Do not connect or disconnect under residual pressure.
- Top quality elastomer seals provide maximum sealing.
- The external sealing ring ensures a solid connection and prevents disconnection due to vibration.
- The design prevents pressure drops and turbulences.
- Durable, safe, compact and easy to use design.
- Please clean the mating surfaces thoroughly before connecting, in order to prevent contaminants to enter into the system.
- Please make sure that the male and female parts are aligned properly to achive full connection.

WARNING

- Connection and disconnection under dynamic pressure is not allowed.
- Connection and disconnection is not allowed when the temperature of the circulating fluid is above 80°C / 176°F.
- Make sure the system pressure is below the maximum working pressure.
- Please ensure that the OLEOCON product you have chosen is compatible with the temperature , material and pressure requirements of your system.
- Please contact OLEOCON technical support for any further questions.

TECHNICAL DRAWING

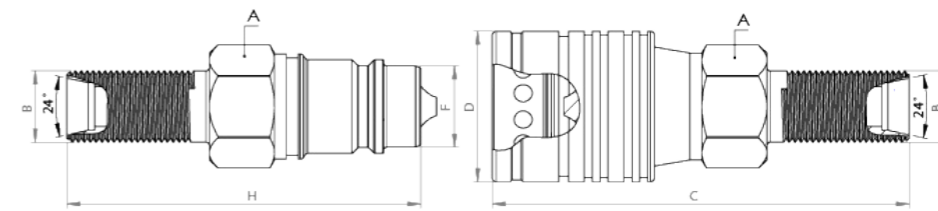

BODY SIZE	DESCRIPTION	COUPLING GENDER	THREAD TYPE	Hex		THREAD SIZE(B)	DIAMETER		LENGTH		WEIGHT				
				mm	inch		mm	inch	mm	inch	kg	lbs			
12,5	PPB-12A-12L	FEMALE	M	A	27	1,06	M18*1,5	D	38	1,49	C	105,5	4,01	0,32	0,70
	PPB-12B-12L	MALE	M	A	27	1,06	M18*1,5	F	20,48	0,8	H	89,5	3,52	0,14	0,30

ISO 8434-1

TECHNICAL DRAWING

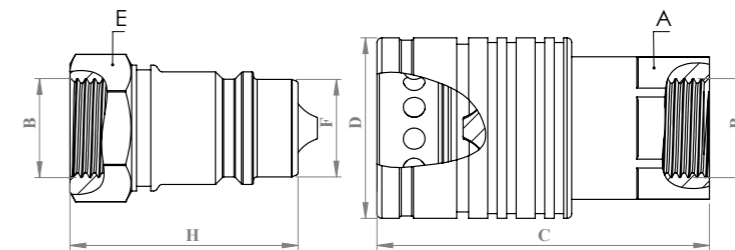

BODY SIZE	DESCRIPTION	COUPLING GENDER	THREAD TYPE	Hex		THREAD SIZE(B)	DIAMETER		LENGTH		WEIGHT				
				mm	inch		mm	inch	mm	inch	kg	lbs			
12,5	PP-12A-G12	FEMALE	BSP	A	27	1,06	1/2"	D	38	1,49	C	69	2,71	0,3	0,66
	QCA-12B-G12	MALE	BSP	E	27	1,06	1/2"	F	20,48	0,8	H	53,5	2,10	0,09	0,19

ISO 1179-1

PUSH PULL



[CLICK HERE FOR 3D SECTION](#)

TECHNICAL FEATURES AND OPTIONS

Locking Mechanism Locking Ball System	Flow Rate Up to 45 l / min	Material Carbon Steel Stainless Steel Brass
Working Temperature -20 °C / +100 °C	Interchange ISO 7241-A	How to Connect Push
Operating Pressure Up to 250 Bar	Available Threads BSP - Metric	Under Residual Pressure Connetion: not Allowed Disconnection: not Allowed
Body Sizes ISO 12.5	Sealing Description NBR - FKM	Valve Type Popet

MAIN APPLICATIONS



TECHNICAL DRAWING

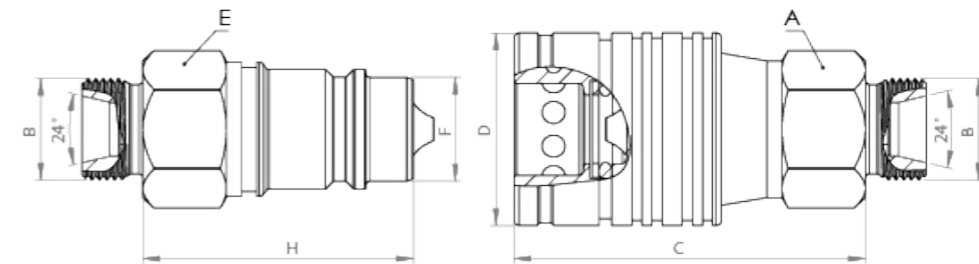

BODY SIZE	DESCRIPTION	COUPLING GENDER	THREAD TYPE	Hex		THREAD SIZE(B)	DIAMETER		LENGTH		WEIGHT				
				mm	inch		mm	inch	mm	inch	kg	lbs			
12.5	PP-12A-12L	FEMALE	M	A	27	1.06	18*1.5	D	38	1.49	C	80.5	3.16	0.30	0.66
	PP-12B-12L	MALE	M	E	27	1.06	18*1.5	F	20.48	0.8	H	64.5	2.53	0.11	0.24
	PP-12A-12S	FEMALE	M	A	27	1.06	20*1.5	D	38	1.49	C	81.5	3.2	0.31	0.68
	PP-12B-12S	MALE	M	E	27	1.06	20*1.5	F	20.48	0.8	H	65.5	2.57	0.12	0.26
	PP-12A-15L	FEMALE	M	A	27	1.06	22*1.5	D	38	1.49	C	81.5	3.2	0.31	0.68
	PP-12B-15L	MALE	M	E	27	1.06	22*1.5	F	20.48	0.8	H	65.5	2.57	0.12	0.26
	PP-12A-16S	FEMALE	M	A	27	1.06	24*1.5	D	38	1.49	C	83.5	3.28	0.31	0.68
	PP-12B-16S	MALE	M	E	27	1.06	24*1.5	F	20.48	0.8	H	67.5	2.65	0.12	0.26

ISO 8434-1

BODY SIZE	WORKING PRESSURE						BURST PRESSURE					
	COUPLE		FEMALE		MALE		COUPLE		FEMALE		MALE	
	MPa	PSI	MPa	PSI	MPa	PSI	MPa	PSI	MPa	PSI	MPa	PSI
12.5	25	3625	25	3625	25	3625	100	14500	100	14500	100	14500

BODY SIZE	RATED FLOW			FLUID LOSS PER DISCONNECT	CONNECTING FORCE		DISCONNECTING FORCE	
	PRES.DROP (kPa)	L/MIN	GPM	ml	N	lbf	N	lbf
12.5	200	45	9.91	2.5	90	20.22	45	10.11

INFORMATION

- Do not connect or disconnect under residual pressure.
- Top quality elastomer seals provide maximum sealing.
- The external sealing ring ensures a solid connection and prevents disconnection due to vibration.
- The design prevents pressure drops and turbulences.
- Durable, safe, compact and easy to use design.
- Please clean the mating surfaces thoroughly before connecting, in order to prevent contaminants to enter into the system.
- Please make sure that the male and female parts are aligned properly to achive full connection.

WARNING

- Connection and disconnection under dynamic pressure is not allowed.
- Connection and disconnection is not allowed when the temperature of the circulating fluid is above 80°C / 176°F.
- Make sure the system pressure is below the maximum working pressure.
- Please ensure that the OLEOCON product you have chosen is compatible with the temperature , material and pressure requirements of your system.
- Please contact OLEOCON technical support for any further questions.