

FLAT FACE SCREW - APA SERIES

TECHNICAL DRAWING

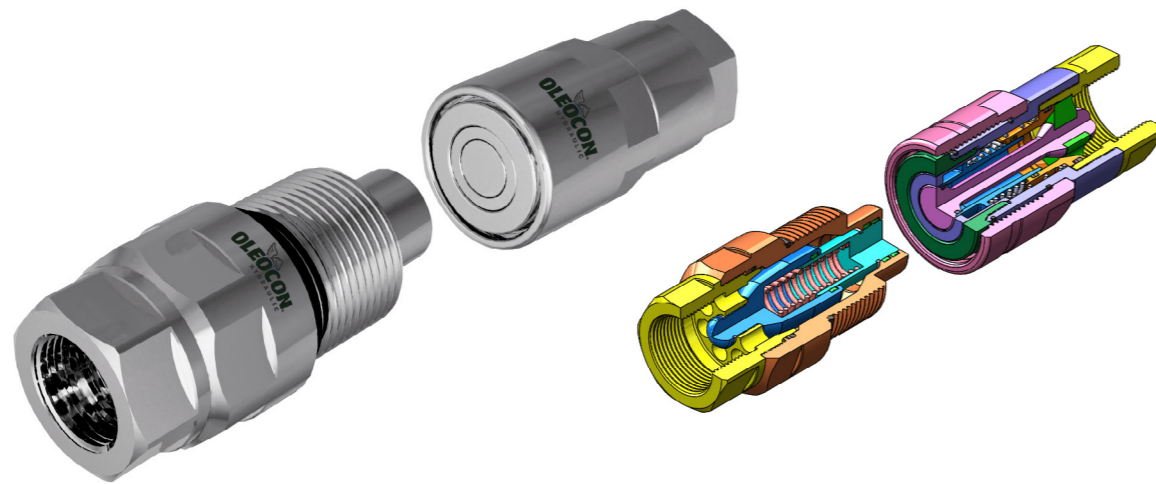

[CLICK HERE FOR 3D SECTION](#)

TECHNICAL FEATURES AND OPTIONS

- Locking Mechanism**
Screw to Connect
- Flow Rate**
Up to 189 l / min
- Material**
Carbon Steel
Stainless Steel
- Working Temperature**
-20 °C / +90 °C
- Interchange**
Oleocon
- How to Connect**
Screw
- Operating Pressure**
Up to 350 Bar
- Available Threads**
BSP
- Under Residual Pressure**
Connection: Both Side
Disconnection: Allowed
- Available Sizes**
From 1" to 1-1/4"
- Sealing Description**
NBR - FKM
- Valve Type**
Flat Face

MAIN APPLICATIONS

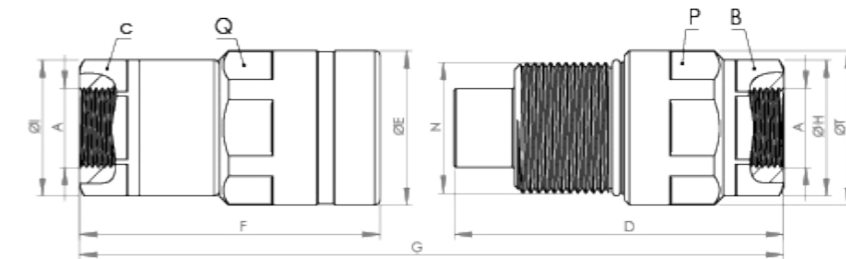

BODY SIZE	DESCRIPTION	CAUPLING GENDER	N	HEX		HEX		THREAD SIZE (A)	DIAMETER		LENGHT		OVERALL LENGHT		WEIGHT						
				mm	inch	mm	inch		mm	inch	mm	inch	mm	inch	Kg	Lbs					
19	APA-19A-G1	FEMALE	M50x3	C	46	1.81	Q	55	2.17	1"	E	59	2.33	F	115	4.54	G	218	8.62	0.413	0.909
	APA-19B-G1	MALE		B	46	1.81	P	55	2.17	1"	T	59	2.33	D	126	4.98					0.665
25	APA-25A-G114	FEMALE	M58x3	C	55	2.17	Q	65	2.57	1-1/4"	E	70	2.77	F	123	4.86	G	234,5	9.27	0.524	1.153
	APA-25B-G114	MALE		B	55	2.17	P	65	2.57	1-1/4"	T	70	2.77	D	135	5.33					0.974

BSPP ISO 1179-1

BODY SIZE	WORKING PRESSURE						BURST PRESSURE					
	COUPLE		FEMALE		MALE		COUPLE		FEMALE		MALE	
	MPa	PSI	MPa	PSI	MPa	PSI	MPa	PSI	MPa	PSI	MPa	PSI
6	-	-	-	-	-	-	-	-	-	-	-	-
19	35	5076	35	5076	35	5076	100	14500	100	14500	100	14500
25	30	4350	30	4350	30	4350	80	11600	80	11600	80	11600

BODY SIZE	RATED FLOW		
	PRES.DROP (kPa)	L/MIN	GPM
19	200	-	-
25	200	-	-

INFORMATION

- Connection under residual pressure is allowed on both sides.
- Disconnection under residual pressure is allowed.
- Flat face design prevents dirt and dust accumulation in the system.
- Top quality elastomer seals provide maximum sealing and prevent oil leakage during disconnection.
- Laminar flow prevents pressure drops and turbulences.
- Durable, safe, compact and easy to use design.
- Please clean the mating surfaces thoroughly before connecting, in order to prevent contaminants to enter into the system.
- Please make sure that the male and female parts are aligned properly to achive full connection.

WARNING

- Connection and disconnection under dynamic pressure is not allowed.
- Connection and disconnection is not allowed when the temperature of the circulating fluid is above 80°C / 176°F.
- Make sure the system pressure is below the maximum working pressure.
- Please ensure that the OLEOCON product you have chosen is compatible with the temperature , material and pressure requirements of your system.
- Please contact OLEOCON technical support for any further questions.